

Windows and doors (continued):

It is best to place the window assemblies into their openings as they are done. See diagram 3 for placement. The peel-and-stick on the frame will be enough to hold them into place.

The door is also built up from layers. Remove the backing from the outer door trim panel and apply it to the backing panel as shown. Mount the outer frame section to the door, then insert the completed door into the wall opening. Again, refer to the diagram for placement.

Outer beams:

4) Before you install the outer support beams read ahead in the instructions to step 8D first. You will need to determine how you want to position the rear loading shed before proceeding.

The peel-and-stick outer wall supports are on trim sheet 2. Once you have planned the loading shed's location you can start applying the supports, applying the side sections first. Apply place over the small etched squares on the walls so that they cover the seam between the two sets of wall pieces.. Now add the front and rear pieces which will overlap the side pieces to give you nice clean corners. The two smaller pieces will fit on each side of the front door.

Trim:

5A) To help identify the parts the corner trim sections are arranged on the parts sheet in the same configuration that they will be installed on the building. Note that each corner consists of a wide and narrow piece. Starting at the bottom of the building, add the trim pieces to the corners of the structure, applying the narrow section first, flush with the edge of the wall. Next, apply the wider trim section so that it overlaps the edge of the narrower piece to form an even corner. There are no trim pieces for the back corner of the building where the shed will be located.

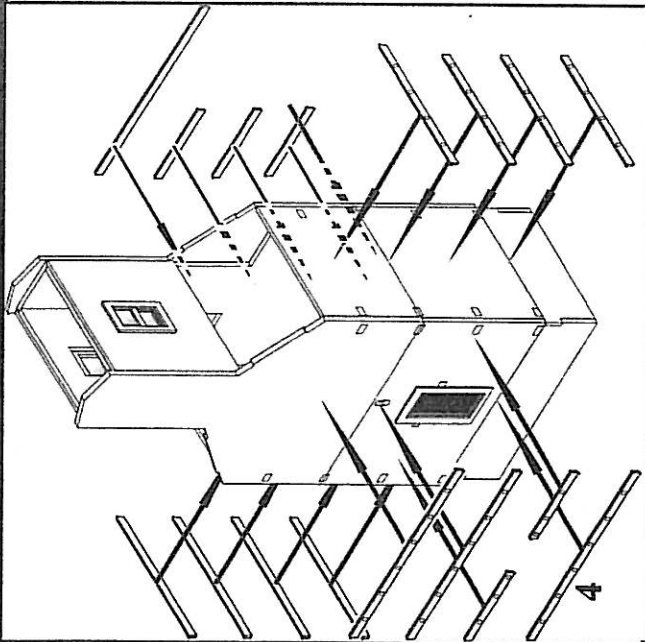

4

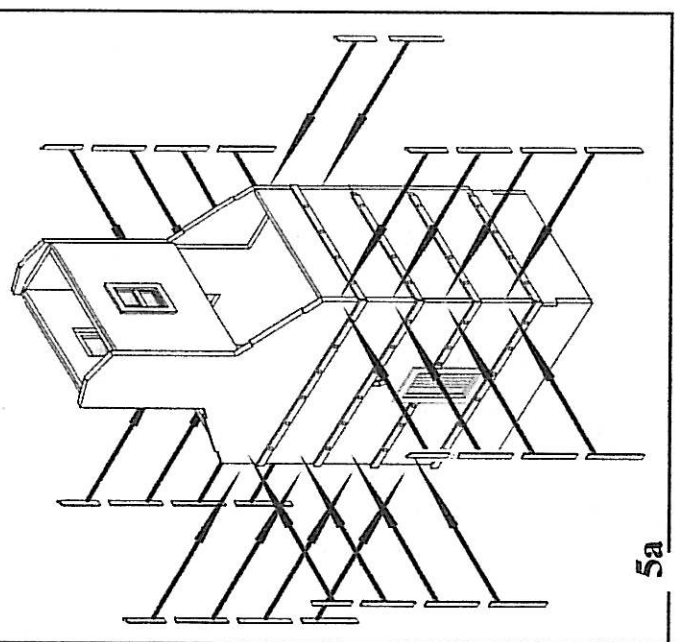

5a

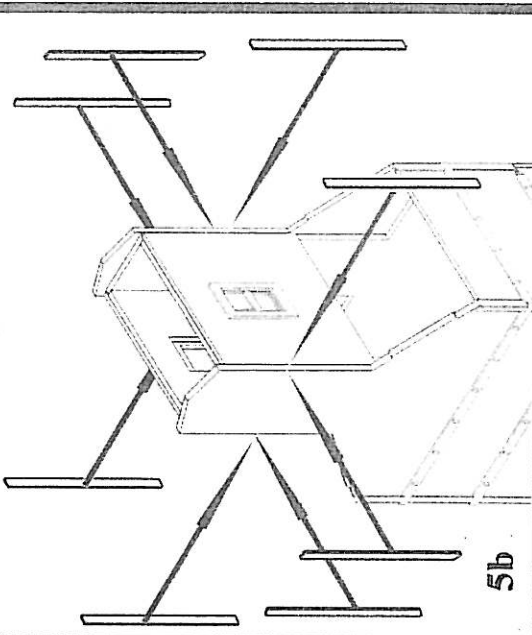

5b

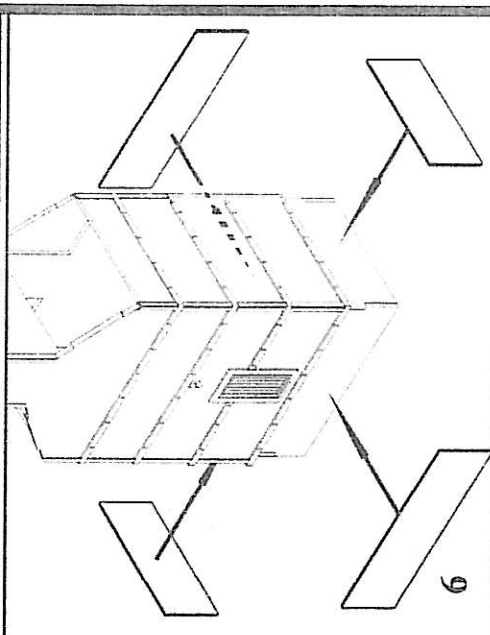

6

5B) The upper tower trim pieces are cut to match the roof angles. Double check the fit of each piece before pressing them into place. Overlap the side trim as you did below.

Foundation:

6) There are 4 sections of peel-and-stick plastic stone foundation panels. Remove the backing from each piece and apply to the lower areas of the building as shown.