

1

Constructing the shell:

1) We'll start with construction of the main building walls. Take the front and rear wall and one larger side wall and glue them together using white glue. You can then locate the other three side wall panels and glue them into their proper locations. Make sure the whole assembly is square and set aside to dry.

Loading dock:

2) Using white glue, assemble the two loading dock side walls to the loading dock front wall. Now glue this assembly to the dock flooring by fitting the bottom tabs into the holes in the base. Then glue the completed loading dock into the two holes on the main wall of the building.

Windows and Doors:

3) The parts for the windows are on the trim sheet. To construct the windows first remove the peel-and-stick window sash and apply a section of clear glazing to it. Now take the window frame and remove the peel-and-stick from it. Center the window sash assembly into the frame and press into place.

It is best to place the various window assemblies into their openings as they are completed. The peel-and-stick on the frame will be more than enough to hold them into place. See diagram 3a for placement.

There are 2 regular and one loading dock door needed. For each door, remove the peel-and-stick from the outer door panel and apply it to the inner panel. The doors can then be applied to the inside of the front wall and the peel-and-stick door trim applied to the outside of the wall. This will hold the door into place.

The dock door is modeled to represent a sliding door. Attach the upper door track to the top of the wall section using the peel-and-stick backing. The area where this will locate is scribed into the wall section for proper placement. Now remove the backing from the door place it in the desired position -open or closed.

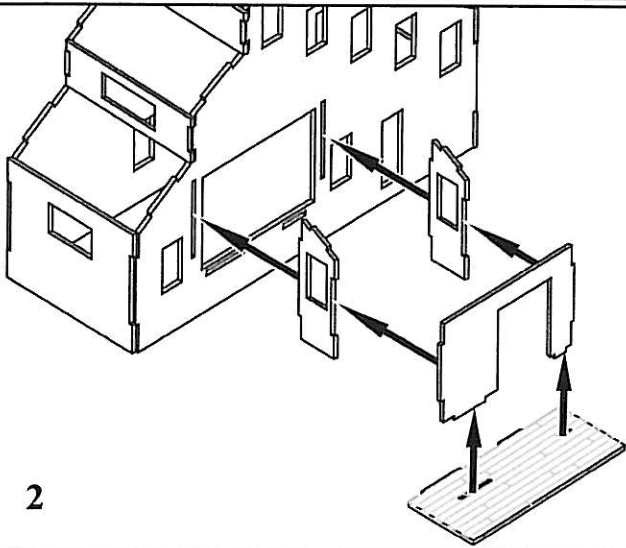

2

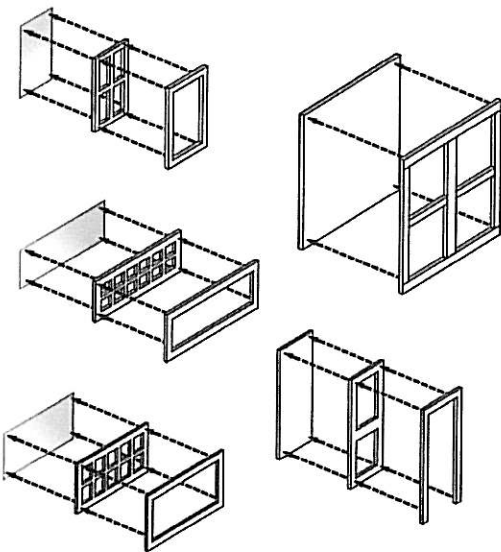

3

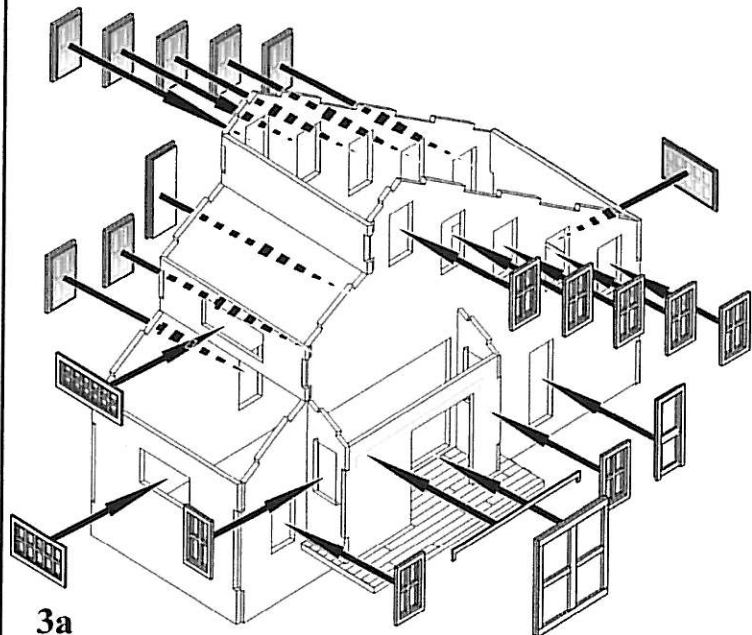

3a