

### Constructing the shell:

1) We'll start with construction of the basic shell. Start by locating the four outer wall sections. Each wall assembly will fit together by gluing them at the tabs on each side. Use a square or angle block to check that the walls are square, then set them aside to dry.

### Windows and doors:

2A) The parts for the windows are on the 1/64 trim sheet. First remove the peel-and-stick from the lower sash and apply a section of clear window glazing to it. Repeat with the upper sash and frame it being sure to keep the edge of the glazing flush with the top edge of the window. Now stick the lower sash into place on the frame. For a little interest and variety it is possible to position the lower sash in an open position. Now take the window frame and remove the peel-and-stick from it. Center the window sash assembly into the frame and press into place.

It is best to place the various window assemblies into their openings as they are done. The peel-and-stick on the frame will be more than enough to hold them into place. See diagram 2B for placement.

The doors assemble in the same manner as the windows. Apply the inner door panel to the outer door panel for each door. Locate each door into their proper locations, the door frame will hold them in position. See diagram 2B for placement.

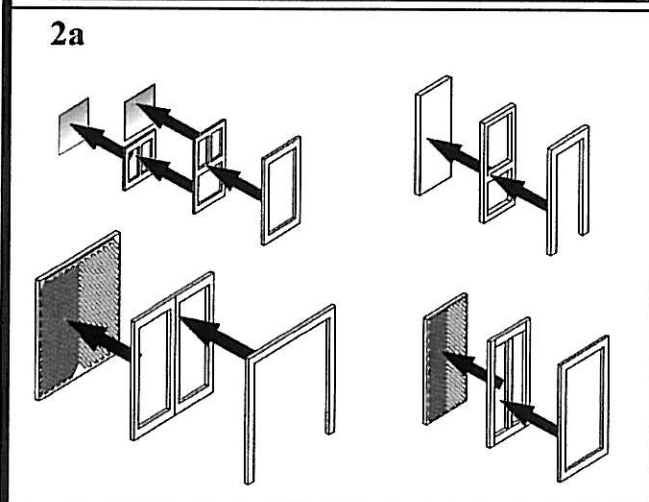

### Trim:

3) Start by removing the peel-and-stick backing from the top side trim pieces and press them into place. Next install the trim boards for each side. Once the side pieces are in place, install the front and rear pieces. Note that these trim pieces contain both the top and side trim all in one piece. The front and rear trim will slightly overlap the side trim giving you a nice clean corner. Note that the front trim has a notch on the bottom to allow it to fit around the front door.

