

1

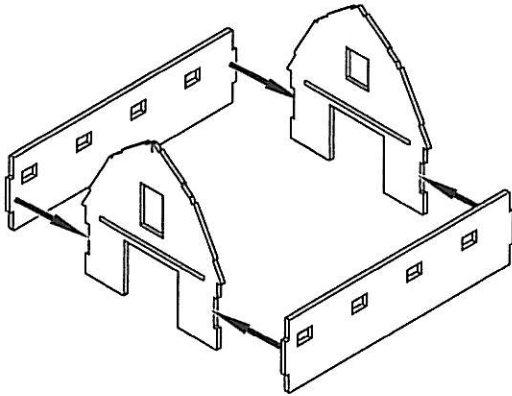

Large barn:

Walls:

1) Assemble the 4 outer walls by gluing them together at the tabs on each end of the walls. Square them up allow to dry.

Inner stalls:

2A) Take the two large stall walls and glue them to the top of the three smaller walls as shown. Make sure they are square and set them aside to dry.

2B) Glue the eight stall doors to the front of each stall. Note that the doors can be placed open if desired.

2C) Making sure that the notched out section where the floor will sit (see 2D) is facing the front of the barn, insert the completed stall section into the barn walls and glue in place.

2D) Glue the flooring to the upper part of the barns stalls as shown

Windows:

3) Remove the peel-and-stick backing from each window frame and apply the clear glazing to it. Now remove the backing from the outer window frame and apply the window to the center of it. The entire window assembly can then be pressed into the opening, the peel and stick adhesive on the frame will be more than enough to hold it in place.

Trim:

4) Apply the four small outer trim pieces to the sides of the barn. Now install the larger end trim pieces. Note that the two large pieces should overlap the side trim for a nice clean corner. Lastly, apply the two upper door tracks to each end as shown. (There is a scribed area on the end walls where these pieces will sit).

2a

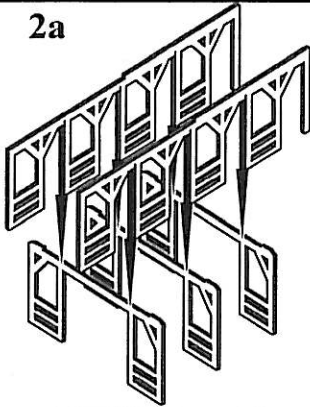

2b

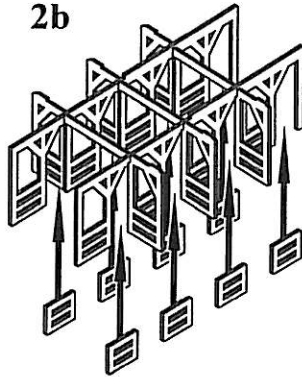

2c

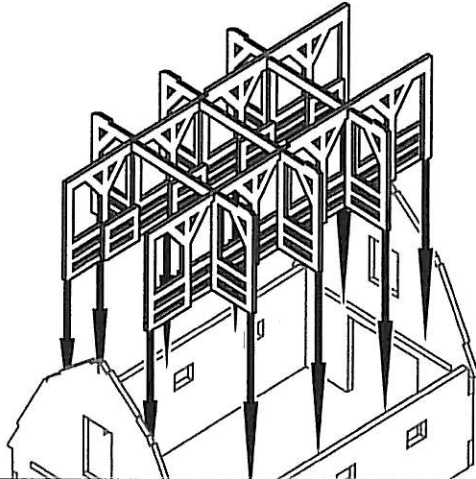

2d

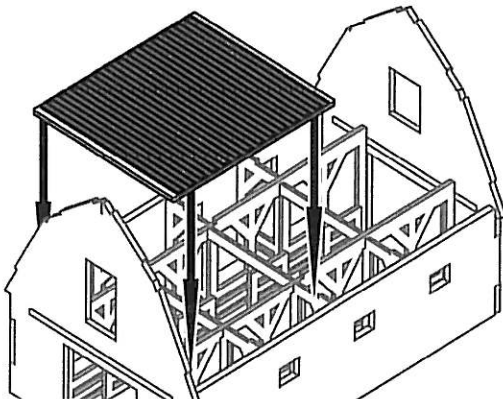

3

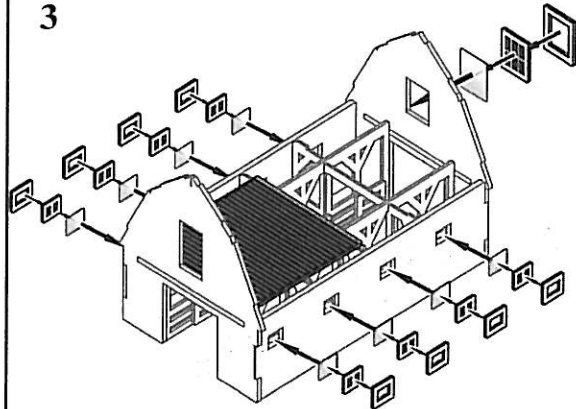

4

