

3d

3D) Glue the two sub roof panels into place on top of the lower facade. The lower panel tabs into the front wall and sits on top of the walls and brackets. The larger sub roof panel glues to the top of the lower one.

**Windows and doors:**

4) There are 35 window assemblies needed (the bay windows will be assembled later) so this step may take a little time! Paint the window frames before assembly; it will make for a much faster and neater job. Install each window into its opening as its completed. The peel-and-stick adhesive will be more than enough to hold it in place. Note that the divided light windows are for the second story and the smaller single panel windows are for the third story.

To assemble a typical window, first remove the peel-and-stick from the lower sash and apply a section of clear window glazing to it. Repeat with the upper sash and frame it being sure to keep the edge of the glazing flush with the top edge of the window. Now stick the lower sash into place on the frame. (Note that it is possible to position the lower sash in an open position if you want to add a little character to your building). Now take the window frame and remove the peel-and-stick from it. Center the window sash assembly into the frame and press into place.

**Doors:**

4) Assemble the back door by removing the backing from each outer door frame and applying it to the door panel keeping the door panel centered side-to-side and flush with the bottom edge. The completed door can then be pressed into their proper openings.

**Third Story front wall:**

5) There are two optional wall sections included for the sloping front wall - a clapboard piece which matches the rest of the building or a plain section that can be covered in roofing shingles for a somewhat fancier look as shown in the photos.

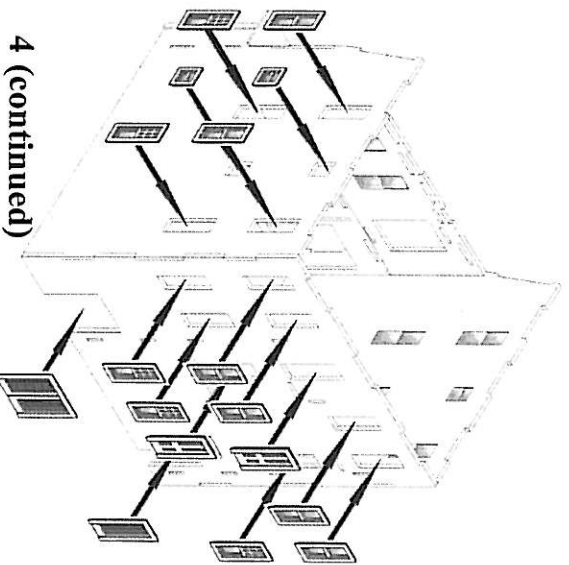
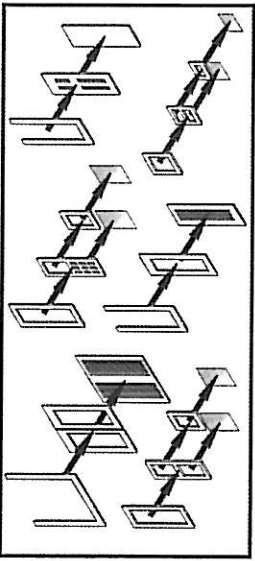

4 (continued)

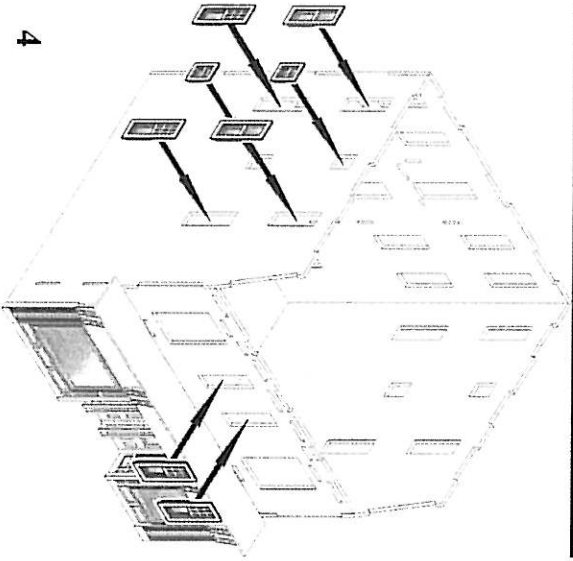

4

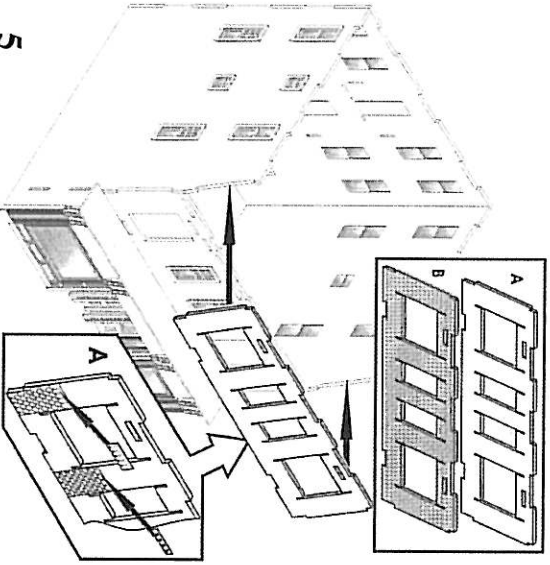

5

Choose which version you want to build and glue the appropriate panel into place at the top of the building as shown.