

For peeling clapboards simply cut a vertical joint into the clapboard, then take your knife at a shallow angle and run it along the bottom of the clapboards, undercutting the raised board using the end of your knife peel up the edge of the clapboard.

For a more weathered appearance the walls can be stained with a light gray stain (driftwood or similar) and then dry-brushed (painting with very little paint on the brush) along the grain. This will create a peeling paint effect.

**Before you begin:**

We recommend that you read through the instructions and look at the picture diagrams before you begin each step. This will help prevent any assembly mistakes. Dry fitting pieces before you glue will help as well.

**Constructing the shell:**

1) Start with the construction of the main house by taking the front wall assembly and gluing each side wall section into place. Now glue the rear wall into place followed by the rear side wall and the rear door wall and upper window. Check that all of the corners are square and set aside to dry. Once the glue is dry paint the wall assemblies before you apply the rest of the parts.

**Windows and doors:**

2) To assemble the windows, first remove the peel-and-stick from the lower sash and apply a section of clear window glazing to it. Now do the same with the upper sash and frame making sure to keep the edge of the glazing flush with the top edge of the frame. Now stick the lower sash into place on the frame. Note that it is possible to position the lower sash in an open position if desired. Now take the window frame and remove the peel-and-stick from it. Center the window sash assembly into the frame and press into place.

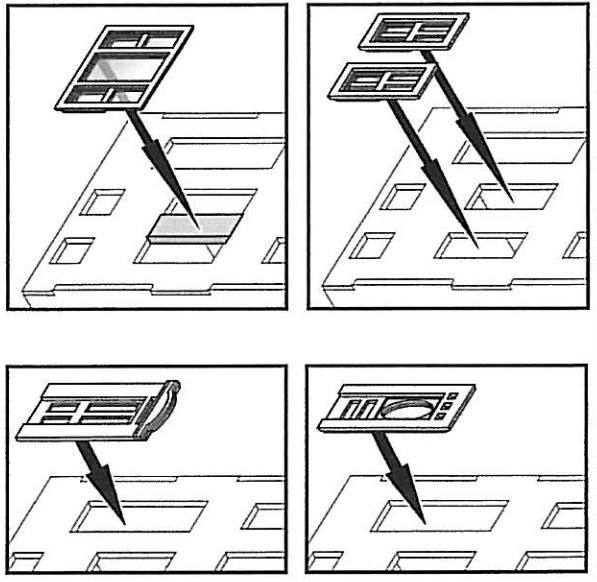

**Optional Doors & Windows**

**NOTE:** There is a larger lower front window that can be used to add a different look to your kit. To install this window, you must trim the center section out of the front wall for it to fit – see the diagram above.

It is best to place the window assemblies into their openings as they are done. See the diagram for placement. The peel-and-stick on the frame will be enough to hold them into place.

The doors are built up from layers. There are two styles of front doors provided. Choose the design that you want to use and assemble and install it as shown. Start by removing the backing from the inner door panel and applying the window glazing to it. Now apply the trim panel to the inner door panel. Finally, mount the outer frame section to the door, then insert the completed door into the wall opening.

