

1

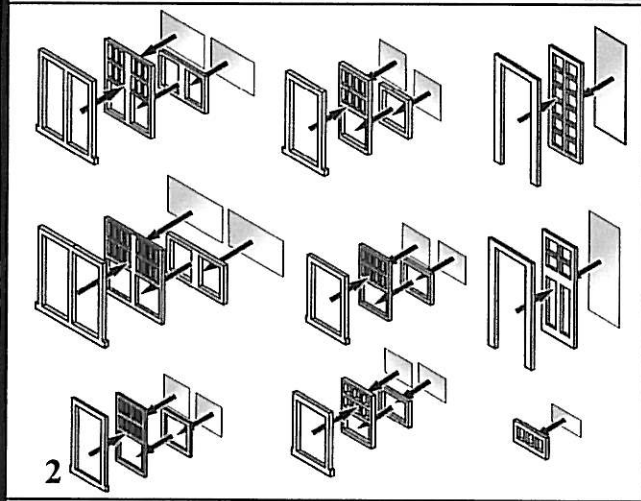

2

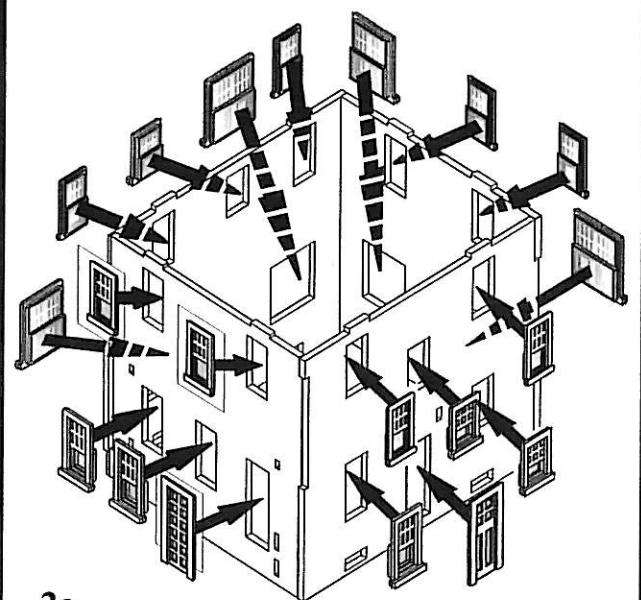

2a

Constructing the shell:

1) Start with construction of the main house walls. Take the front wall assembly and glue each side wall section into place. Note that each wall assembly has pre-cut notches in them that will only line up with the proper adjoining wall. Next glue the rear wall into place. Check that all of the corners are square and set aside to dry. Once dry, paint the wall assemblies before you apply the rest of the parts.

Windows, doors and shutters:

2a) There are a number of window assemblies needed. Parts for these are found on the 1/64 trim sheet. All of the windows assemble in the same fashion. First remove the peel-and-stick from the lower sash and apply a section of clear window glazing to it. Repeat with the upper sash and frame it being sure to keep the edge of the glazing flush with the top edge of the window. Now stick the lower sash into place on the frame. For a little interest and variety it is possible to position the lower sash in an open position. Now take the window frame and remove the peel-and-stick from it. To finish each window add the bottom sill trim to the lower part of the frame. It is best to place the various window assemblies into their openings as they are done. To do so, just center the window sash assembly into the frame and press into place (see diagram 2a for placement). The peel-and-stick on the frame will be more than enough to hold them into place.

The two door assemblies are located on the front and right side of the house. Remove the peel-and-stick from the door and apply the window glazing to the back of it. Now apply the peel and stick trim to the door keeping the door centered side-to-side and flush with the bottom edge. The doors are then installed into their openings using the peel and stick adhesives on the trim to hold them in place.

Side Door Awning:

2c) Glue the two side awning supports to the flat sub-roof piece with the tabs as shown. One the glue has dried, add the angled sub-roof and the two small triangle side trim pieces (found on the trim sheet). Attach the completed assembly to the house by fitting the tabs on the back of the awning into the holes in the side of the house.

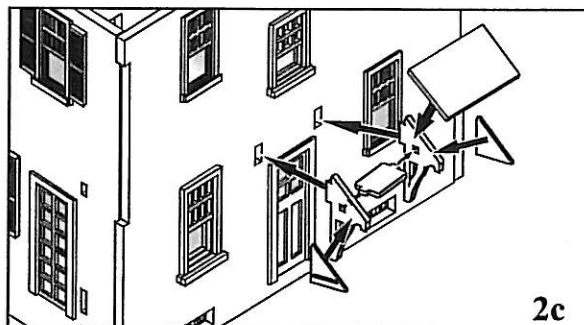

2c