

7

Paper roofing:

7) Apply the roofing shingles using white glue. Start at the bottom of each roof edge, gluing each strip of roof paper overlapping the previous row as you go up and staggering the joints between shingles as shown. You will need to cover the main roof and the front and rear porch roofs.

The completed shingles can then be painted and weathered as desired. We like to use a slate gray paint and dry brush lighter shades of color to pick up the highlights.

Chimney:

8) The resin chimney can be located wherever you think it looks best. Although the chimney does have an angled base you may need to sand the base a bit to get it to accurately match the angle of the roof. Paint the chimney, then glue into place using contact cement or ACC.

Your kit is now completed and ready for your layout. We hope you've enjoyed this kit. If you have any problems or comments, please contact us at:

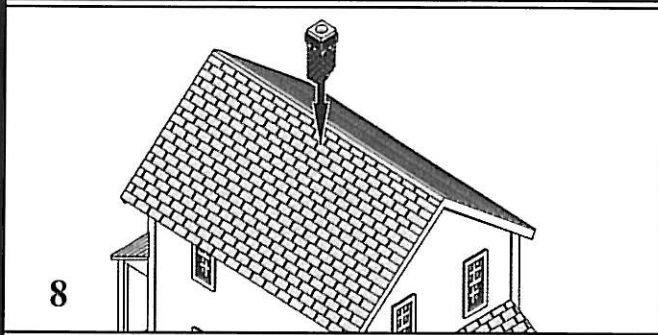

8

Branchline Trains

323 Park Ave. East Hartford, CT. 06108

For a full list of our products, see our web site at www.branchline-trains.com

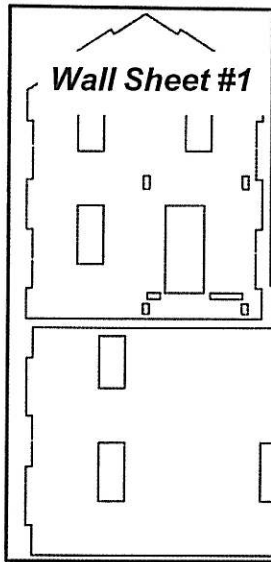

Wall Sheet #1

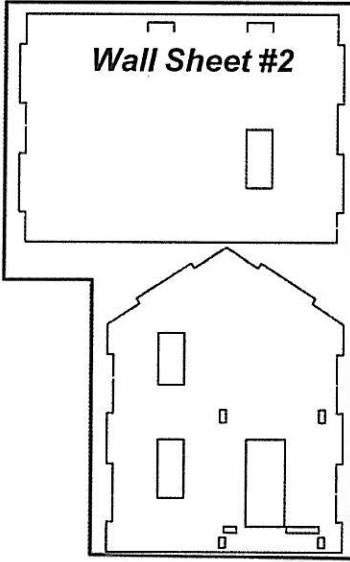

Wall Sheet #2

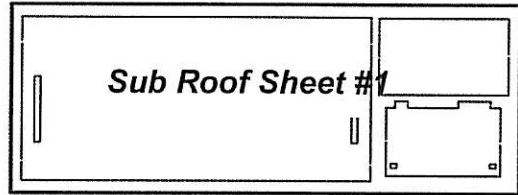

Sub Roof Sheet #1



Sub Roof Sheet #2

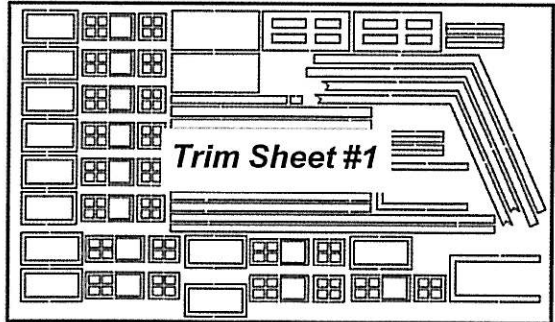

Trim Sheet #1

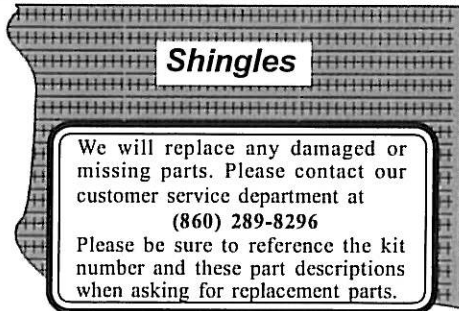

Shingles

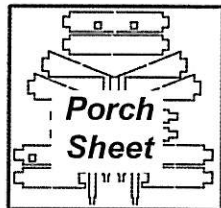

Porch Sheet



Glazing Sheet

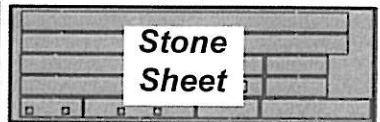

Stone Sheet

We will replace any damaged or missing parts. Please contact our customer service department at (860) 289-8296. Please be sure to reference the kit number and these part descriptions when asking for replacement parts.